

8 7 6 5 4 3 2 1

H
G
F
E
D
C
B
A

H
G
F
E
D
C
B
A

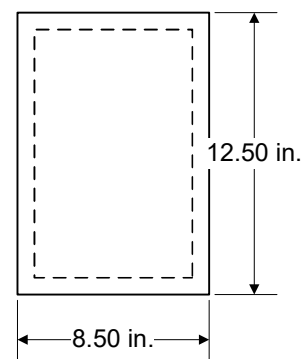
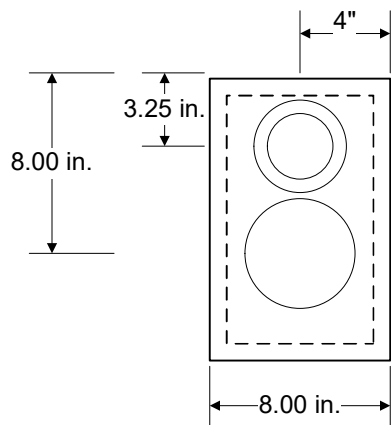

Simplified Drawing – no internal battens shown.

Tweeter Cut out:
 105 mm outer, 3.4 mm recess
 74 mm inner + "ears" for terminals

Woofer cut out:
 4-7/8" , Front opening
 6.25" Back side recess hole,
 6mm Deep.

It is strongly recommended that you cut the holes from your measured drivers as frame sizes can vary from production run.

Cabinet fill: Pyramid foam

Tweeter: RS28A / CAT308 for Continuum II (will need to route out for terminals accordingly)

Woofer: AC130F1

Cabinet material: 3/4" MDF, Many have use solid hardwood with good results.

Terminal cut out as required



Meniscus Audio Group. Inc.			
REV	Continuum or Continuum II by Jeff Bagby	5/1/2010	APPROVED

8 7 6 5 4 3 2 1